

SPEAKEASY 5

CORDED TELEPHONE WITH CALLER
DISPLAY AND SPEAKERPHONE

USER GUIDE

Unpacking your SPEAKEASY 5

In the box are:

- Base Unit
- Handset
- Coiled Handset cord
- Telephone line cord for Base Unit
- Mount Bracket
- 2 Screws for wall mounting
- User manual



Keep the packaging materials in a safe place in case you later need to transport the unit.

Keep your sales (till) receipt, which is your guarantee.

Binatone

If you need help ...

The Binatone Help Line is available from 9.00 am to 5.00 pm, Monday to Friday, on

0845 345 9677

Calls are charged at Local Call rate.

Important note — back up batteries

The SpeakEasy 5 requires 3 x 1.5V AA size Alkaline batteries installed into the battery compartment before use.

Warning: The caller display will not work without batteries installed.

I. Where to find it

UP-DOWN (CDS) Buttons
- Scrolls through the Caller display records, and scrolls through the lists and options.

One Touch Memory Buttons
- Press to call numbers stored on One Touch memory.

SPEAKERPHONE light
- Lights up when using the speakerphone.

NEW CALL light - Flashes when you have new Caller Display records.

MUTE Button
- Press during a call to mute the microphone or mouthpiece.

STO (STORE) Button
- Press to store phone numbers in memory.

C (CANCEL) Button
- Press to delete the displayed Caller display, Phonebook, or Outgoing call record.

RINGER light
- Lights up when receiving a call.

(MENU) Button
- Press to enter Options Menu to set the Date, Time, Screen Contrast, and other phone settings.

DIAL Button
- Press to dial out the displayed record.

(PHONEBOOK) Button - Press to access the Phonebook records.

IN USE light
- Lights up when the Handset is in on line mode.

SPEAKER Volume switch - Used to adjust the volume level of the Speakerphone.

(REDIAL)/ P (PAUSE) Button
- Press to access the LNR lists when in standby mode. Press to insert a pause when dialing.

(SPEAKERPHONE) Button
- Press to make, answer, or end a call using the speakerphone.

R (RECALL) Button
- During programming, press to return to standby mode. Press to answer a call if you have 'Call waiting.' Press if you use BT's Selected Services.

Important:

- When the instruction simply say 'press' a button, this means you should press it briefly then release it.
- When the instruction say 'press and hold' a button, this means you should keep it pressed until the display changes or you hear a tone.



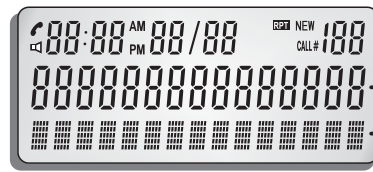



Display messages and symbols



Number field: It shows the telephone number.

Letter field: It shows the name, and the status of a call.

The LCD screen icons:

	Phone	You are connected to the telephone line - your Handset is 'offhook'.
	Time	Displays the time.
	Date/Month	Displays the day and month setting.
	Caller Display Record	Shows the total number of Caller Display records.
	NEW	Appears when you have new messages and/or Caller Display records.
	Repeat	Appears when a caller has called more than once.
	Speakerphone	Appears when the speakerphone function is turned ON.

Binatone Help Line - 0845 345 9677

Calls are charged at Local Call rate.

2. Installation

1. Locating the Base unit

The Base unit should be placed on a level surface, in a position where:

- the **telephone line cable** will reach your telephone line socket or extension socket.
- it is **not close to a sink, bath or shower**, or anywhere else where it might get wet.
- it is **not close to other electrical equipment** - fridges, washing machines, microwave ovens, TVs, fluorescent lights, etc.

2. Plug the coiled handset cord into the Handset. Plug the other end into the jack on the left side of the Base unit.

3. Place the Handset in the Base unit.

4. Plug the telephone line cord into the PHONE LINE jack at the back of the Base unit. Plug the other end into a modular wall jack.

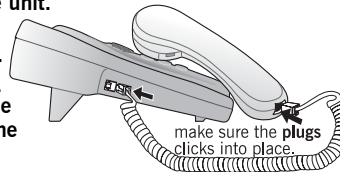

5. Lift the Handset and check for Dial tone in the earpiece.

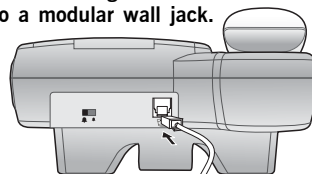

Always use the telephone line cord supplied with your SpeakEasy 5. Other telephone line cords may not work.

Installing Backup batteries

1. Remove the Battery cover and insert 3 X 1.5V AA size alkaline batteries (not included) into the battery compartment paying attention to the polarity marking as shown inside the compartment.

2. Replace the battery cover until it clicks into place.

Warning: Disconnect the telephone from the telephone line before changing the batteries.

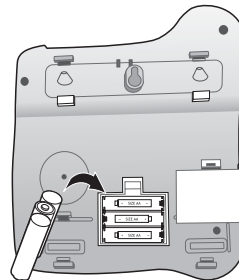

Note: The Caller display will not work without batteries installed.

3. Desk/Wall mount installation

Desk Mount

To place the SpeakEasy 5 on a desk, connect the stand to the bottom of the phone in the slots near the ringer cover as shown below.

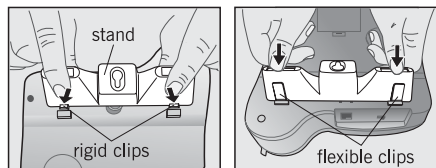

Insert the rigid clips of the stand into the slots on the bottom of the phone (near the ringer cover). Press down firmly until the flexible clips clicks into place.

To remove the stand, (1) pinch the flexible clips, (2) pull back the stand, and then (3) slide up and forward (3) as shown below.

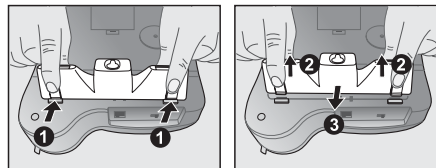

Wall Mount

To place the SpeakEasy 5 on a wall, connect the stand to the bottom of the phone in the slots near the battery cover as shown below.

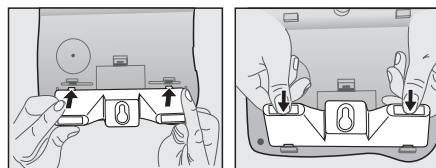

Desk/Wall mount continue...

Insert the rigid clips of the stand into the slots on the bottom of the phone (near the battery cover). Press down firmly until the flexible clips clicks into place.

To remove the stand, (1) pinch the flexible clips, (2) pull back the stand, and then (3) slide up and forward as shown below.

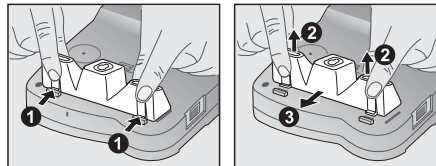

Mark two points on the wall that are 137mm apart to lay the fixing centers as shown below.

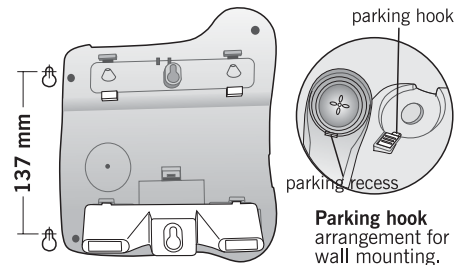

BE CAREFUL to check that there are no electrical wires hidden in the wall. Fix two screws (supplied with the unit) at the marked locations, leaving approximately 7mm between the wall and the screw head. Hang the cradle unit on the screws using the wall mount slots. *You may need to remove the telephone from the wall and tighten the screws so that the cradle is securely fixed and does not wobble.* Place the Handset on the cradle with the **parking hook** on the cradle arranged to fit in the **parking recess** under the earpiece on the Handset.







4. Setting up your phone

The following section details how to set up your telephone. Press the **MENU** button to enter the **Options** menu and then use the **UP** or **DOWN** buttons to cycle through the following options:

- **SET LANGUAGE**
- **SET TIME/DATE**
- **LCD CONTRAST**
- **SET FLASH TIME**
- **EXIT OPTION**

! **Note:** The system will time out if you leave more than 15 seconds between key presses.

SET LANGUAGE













- | | | |
|---|---|---|
| 1 |  | With the phone in standby mode:
Press MENU button.
⇒ The display shows OPTIONS MENU ▲▼ . |
| 2 |  | Press UP button to go to the language setting.
⇒ The display will show SET LANGUAGE . |
| 3 |  | Press MENU button to confirm. |
| 4 |  | Press UP or DOWN button to select one of the 11 languages: ENGLISH, FRENCH, SPANISH, GERMAN, ITALY, PORTUGUESE, TURKISH, DANISH, POLISH, SWEDISH, and DUTCH. |
| 5 |  | Press MENU button to confirm. |
| 6 |  | Continue with programming, or press RECALL button to return to standby mode. |

SET TIME/DATE



- | | | |
|---|---|--|
| 1 |  | The date and time on your phone can be synchronized with the local date and time if you have subscribed to the Caller Display service from your telephone company. (This feature is only available for an analogue PSTN (not ISDN) line).

However, you can set the date and time manually:
Press MENU button.
⇒ The display shows OPTIONS MENU ▲▼ . |
|---|---|--|

Setting up continue...





- 2  Press UP or DOWN button until the display shows SET TIME/DATE.
- 3  Press MENU button to confirm.
⇒ The 'year' icon will be blinking.
- 4  Press UP or DOWN button to set the year.
- 5  Press MENU button to confirm.
⇒ The 'month' icon will be blinking.
- 6  Press UP or DOWN button to set the month.
- 7  Press MENU button to confirm.
⇒ The 'date' icon will be blinking.
- 8  Press UP or DOWN button to set the date.
- 9  Press MENU button to confirm.
⇒ The 'hour' icon will be blinking.
- 10  Press UP or DOWN button to set the hour.
⇒ When setting the 'hour', the 'AM' or 'PM' icon will automatically turn ON to correspond the hour time.
- 11  Press MENU button to confirm.
⇒ The 'minute' icon will be blinking.
- 12  Press UP or DOWN button to set the minute.
- 13  Press MENU button to confirm the TIME and DATE setting.
- 14  Continue with programming, or press RECALL button to return to standby mode.

LCD CONTRAST







- 1  Press MENU button.
⇒ The display shows OPTIONS MENU ▲▼.
- 2  Press UP or DOWN button until the display shows LCD CONTRAST.

Binatone Help Line - 0845 345 9677 Calls are charged at Local Call rate.

Setting up continue...

- | | | |
|---|---|---|
| 3 |  | Press MENU button to confirm. |
| 4 |  | Press UP or DOWN button to select your comfortable display viewing level (1~6). The default setting is 3. |
| 5 |  | Press MENU button to confirm the LCD CONTRAST setting. |
| 6 |  | Continue with programming, or press RECALL button to return to standby mode. |

SET FLASH TIME

- | | | |
|---|---|--|
| 1 |  | Press MENU button.
⇒ The display shows OPTIONS MENU ▲▼ . |
| 2 |  | Press UP or DOWN button until the display shows SET FLASH TIME . |
| 3 |  | Press MENU button to confirm. |
| 4 |  | Press UP or DOWN button to select 100MS (default), 300MS, or 600MS. |
| 5 |  | Press MENU button to confirm. |
| 6 |  | Press RECALL button to return to standby mode or wait until the program times out. |

5. Telephone Operation

Ringer volume



The **Ringer High-Low switch** located at the back of the Base unit allows you to adjust the volume of the ringer.

- High volume

- Low volume

To make a call



1 Lift the handset, or press **SPEAKERPHONE** button on the Base unit.

⇒ Check for dial tone.

2 Dial the telephone number.

⇒ The display shows the duration of the call in minutes and seconds.

Using the Pre-dial mode



1 Dial the telephone number.

2 Lift the Handset or press **SPEAKERPHONE** button on the Base unit to dial out the number.

Notes:

When using the Speakerphone, speak clearly into the Base unit microphone from a distance of 15 cm (6 in.)

To answer a call



When the phone rings:

Lift the Handset, or press **SPEAKERPHONE** button on the Base unit.

⇒ The display shows the duration of the call in minutes and seconds .

Telephone operation continue...

To adjust the speakerphone volume



During a call:

Adjust the volume of the speakerphone to your comfortable volume level using the **SPEAKERPHONE** volume switch located on the right side of the Base unit.

To end a call



Replace the Handset on the Base unit cradle, or press **SPEAKERPHONE** button on the Base unit.

⇒ The **SPEAKERPHONE** light indicator will turn OFF.

To switch between the Handset and the Speakerphone



During a phone conversation through the Handset, press the **SPEAKERPHONE** button to speak hands-free. Replace the Handset on the Base unit cradle.

While in speakerphone mode, lift the Handset to enable a private conversation.

To mute the mouthpiece or microphone

1



Press **MUTE** button once.

⇒ While the microphone is muted, **MUTE** will be shown on the lower left corner of the display.

2



Press **MUTE** button again to get back to the call.

Inserting a Pause in the dialing sequence





For some switchboard systems, an access number must be dialed (usually an 8 or 9) to get another dial tone and an outside line. Pressing **REDIAL/PAUSE** button immediately after the access number, a pause of about 3.6 seconds will be entered, and the desired number can be dialed immediately.

Press **REDIAL/PAUSE** button to insert a pause when dialing or storing Long Distance Access Codes.

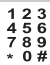

Telephone operation continue...

Storing a Number in memory











- 1  With the phone on standby mode, press **STORE** button.
- 2  Enter the telephone number, up to 22 digits.
⇒ The memory cannot exceed 22 digits during programming and if exceeded, the memory will not store the number.
- 3  Press the desired memory location button (**M1**, **M2**, or **M3**) button.
⇒ The display shows **SAVED!**
- 4  Input the name, maximum of 15 characters using keypad buttons **2/ABC** to **9/WXYZ**.
⇒ See character table on page 16 for entering letters.

Note: When the Memory buttons are full and you wish to store a new number in memory, follow steps 1 to 4. The new number will replace the old number stored in memory.

Speed dialing





- 1  Lift the Handset, or press **SPEAKERPHONE** button on the Base unit.
- 2  Press the One Touch memory location **M1**, **M2**, or **M3** button.
⇒ The number dials automatically.

6. Outgoing call record

Last Number redial	1		Lift the handset or press SPEAKERPHONE button.
	2		Press REDIAL/PAUSE button. ⇒ The phone automatically redials the last number you called.
Viewing the Outgoing call records	1		The telephone remembers the last 10 outgoing calls . In standby mode, press REDIAL/PAUSE button. ⇒ The most recent outgoing call record will be displayed.
	2		Press UP or DOWN button to view the other records.
Making a call from the Outgoing call record	1		In standby mode, press REDIAL/PAUSE button.
	2		Press UP or DOWN button to find the record you wish to call.
	3	 DIAL	When the number is displayed, press DIAL button. ⇒ The phone automatically redials the number using the speakerphone mode. Lift the Handset anytime to talk privately and to turn the speakerphone mode off.
Deleting an Outgoing call record	1		In standby mode, press REDIAL/PAUSE button.
	2		Press UP or DOWN button to find the record you wish to delete.
	3	 C	When the record is displayed, press CANCEL button. ⇒ The display prompts DELETE?
	4	 C	Press CANCEL button again to confirm. ⇒ The display shows next record.

Binatone Help Line - 0845 345 9677 *Calls are charged at Local Call rate.*

Outgoing call record continue...

- | | | | |
|--|---|---|--|
| Storing an Outgoing call record into the Phonebook memory | 1 |  | When viewing the Outgoing call records, press UP or DOWN button to find the record you wish to store. |
| | 2 |  | When the record is displayed, press PHONEBOOK button.
⇒ The display shows the cursor blinking on the first digit of the number.
⇒ To modify the number, press UP or DOWN button to move the cursor to the number you want to change then input the new one or press CANCEL button to delete. |
| | 3 |  | Press PHONEBOOK button to confirm. |
| | 4 | | Input the name. <i>See page 16 for entering letters.</i>
⇒ To modify an existing name, press UP or DOWN button to move the cursor to the character you want to change then input the new one or press CANCEL button to delete. |
| | 5 |  | Press PHONEBOOK button again to save the record into the Phonebook memory. |

7. Phonebook function

To view the Phonebook record

1

The Phonebook can store up to 22 names (maximum of 15 characters) and telephone numbers (maximum of 20 digits) in the Memory.

Make sure the Handset is idle (not connected to a call).

2



Press PHONEBOOK button.

⇒ The display shows **SEARCH ADD**, with the 'SEARCH' option blinking.

3



Press PHONEBOOK button again.

⇒ If the Phonebook memory is empty, the phone will automatically return to the standby display. Otherwise, the first alphanumeric Phonebook entry will be shown.

4



Press NUMERIC key (2/ABC to 9/wxyz) button that corresponds to the first letter of a Caller's name and the search will jump to the first entry in the Phonebook beginning with that letter.

5



Press UP or DOWN button to scroll through the next records.

Notes:

During the Phonebook programming, press **RECALL** button repeatedly to return to standby mode or wait until the program times out.

To add a new record into the Phonebook

1



Press PHONEBOOK button.

⇒ The display shows **SEARCH ADD**, with the 'SEARCH' option blinking.

2



Press UP or DOWN button to select ADD.

3



Press PHONEBOOK button to confirm.

⇒ The display shows the cursor blinking on the name field.

Phonebook function continue...



- 4 **Input the name, maximum of 15 characters using keypad buttons 2/ABC to 9/WXYZ.**
⇒ Refer to the table below to get the following characters.

Telephone Keypad characters

Keypad Buttons	1st Press	2nd Press	3rd Press	4th Press	5th Press
1	1	/	,	.	-
2/ABC	A	B	C	2	
3/DEF	D	E	F	3	
4/GHI	G	H	I	4	
5/JKL	J	K	L	5	
6/MNO	M	N	O	6	
7/PQRS	P	Q	R	S	7
8/TUV	T	U	V	8	
9/WXYZ	W	X	Y	Z	9
0	0	Space			



- 5 **Press PHONEBOOK button to confirm the name.**
⇒ The display shows the cursor blinking on the number field.



- 6 **Input the telephone number, max. of 24 digits.**



- 7 **Press PHONEBOOK button to confirm the number.**



- 8 **Press RECALL button repeatedly to return to standby mode, or wait until the program times out.**

To make a call from the Phonebook









- 1 **When viewing the Phonebook records, press UP or DOWN button to find the record you wish to call.**







- 2 **Press DIAL button.**
⇒ The phone automatically dials the displayed record using the speakerphone mode. **Lift the Handset anytime to talk privately and to turn the speakerphone mode off.**

Binatone Help Line - 0845 345 9677 Calls are charged at Local Call rate.

Phonebook function continue...

To edit a stored number and/or name	1		When viewing the Phonebook records, press UP or DOWN button to find the record you wish to edit.
	2		When the record is displayed, press PHONEBOOK button. ⇒ The display shows the cursor blinking on the first character of the name field.
	3		Press UP or DOWN button to move the cursor to the character you wish to edit then input the new one or press CANCEL button to erase.
	4		Press PHONEBOOK button to confirm the edited name. ⇒ The display shows the cursor blinking after the last digit of the number.
	5		To edit the number, press CANCEL button repeatedly to delete the digits one after the other then key in the new number/s.
	6		Press PHONEBOOK button to save the edited name and/or number.
	7		Press RECALL button repeatedly to return to standby mode or wait until the program times out.

To delete a record from memory	1		When viewing the Phonebook records, press UP or DOWN button to find the record you wish to edit.
	2		When the record is displayed, press CANCEL button. ⇒ The display prompts DELETE?
	3		Press CANCEL button again to confirm. ⇒ The display shows next Phonebook record.
	4		Press RECALL button repeatedly to return to the standby mode or wait until the program times out.

Binatone Help Line - 0845 345 9677 Calls are charged at Local Call rate.

8. Caller Display operation

VERY IMPORTANT: The Caller Display feature of this product requires a subscription to Caller Display service from your telephone company.

If you subscribe to this feature from your local telephone company, you can see the phone number of the person calling you before you answer. The caller display information includes:

- The caller's number.
- The date and time of the call.
- The caller's name if the network sends it.

Note: The Caller Display information will also include a name from the phonebook if the incoming number fully matches an entry in the Phonebook.

The place origin of the Caller Display record will display a special network message as:

Message	Significant
WITHHELD	The caller hides his number.
UNAVAILABLE	The caller's number is out of the network area.

Withheld and Unavailable calls are saved in the calls list and show as missed calls.

Caller Display list

This phone dynamically stores all the calls received (**max. of 199 calls with 8-digit number for every record, or a min. of 60 calls with 15 characters and 15-digit number for every record**). It stores the data even if a power failure occurs. When the caller display list is full, the new caller display entry will replace the oldest record.

Binatone Help Line - 0845 345 9677 Calls are charged at Local Call rate.

Caller Display operation continue...

The '**NEW**' icon will display, and the NEW CALL light indicator will light up to indicate that you have a new Caller Display call stored in memory. It will turn off until you have viewed the new caller display record.

Viewing the Caller Display list

1



With the phone on standby mode, press UP or DOWN button.

⇒ The display shows the most recent record. If there are no Caller Display records, the display will show **NO CALLS**.

2



Press UP or DOWN button again to scroll to the next Caller Display record.

⇒ The display shows **END OF LIST** upon reaching the end of the first and last record.

3



Press RECALL button to return to standby mode or wait until the program times out.

To return a call



When the Caller Display record is displayed.

Press DIAL button.

⇒ The phone automatically dials the displayed record using the speakerphone mode. **Lift the Handset anytime to talk privately and to turn the speakerphone mode off.**

To delete a Caller Display record

1



When the Caller Display record is displayed.

Press CANCEL button.

⇒ The display prompts **DELETE CALL?**

2



Press CANCEL button again to confirm.

⇒ The display shows the next Caller Display record.

3



Press RECALL button to return to standby mode or wait until the program times out.

Caller Display operation continue...

To delete all Caller Display records

1



During the Caller Display review:

Press and hold CANCEL button.

⇒ The display prompts **DEL ALL CALLS?**

2



Press CANCEL button again to confirm.

⇒ The display automatically returns to standby mode.



OR press RECALL button to exit and return to the previous menu.

Storing a Caller Display record into the Phonebook memory

1



During the Caller Display review:

Press UP or DOWN button to find the record you wish to store.

2



When the record is displayed, press PHONEBOOK button.

⇒ The display shows the cursor blinking on the first character of the name field.

3

Input the name if record do not have a name. See page 16 for entering letters.

⇒ To modify an existing name record, press **UP** or **DOWN** button to move the cursor to the character you want to change then input the new one or press **CANCEL** button to erase.

4



Press PHONEBOOK button to confirm.

⇒ The display shows the cursor blinking after the last digit of the number.

5





Press PHONEBOOK button again to save the record into the Phonebook memory.

Caller Display operation continue...

Caller Display with Call Waiting

When you subscribe to Call Waiting service from your local telephone company, this telephone will display the number of the second caller while you are having a conversation with the first caller.

- 1  **When you receive a 'Call Waiting' call and you want to connect the call, press **RECALL** button and start talking with the second caller.**
⇒ The active call will be placed on hold.
- 2  **Press **RECALL** button to alternate between calls.**
- 3  **To end the call, replace the Handset on the Base unit cradle or press **SPEAKERPHONE** button on the Base unit.**

9. Operational notes

Electrical safety

- **DON'T let the Base unit get wet.** Electrical equipment can cause serious injury if used while you are wet or standing in water.
- If the Base unit ever falls into **water**, **DON'T** retrieve it until you have unplugged the telephone line plug from the telephone socket; then pull it out by the unplugged cables.
- **NEVER use your SpeakEasy 5 outdoors during a thunderstorm** - unplug the Base unit from the telephone line when there are storms in your area. Damage caused by lightning is not covered by the guarantee.

Locating the Base unit

The Base unit should be placed on a level surface, in a position where:

- the **telephone line cable** will reach your telephone line socket or extension socket.
- it is **not close to a sink, bath or shower**, or anywhere else where it might get wet.
- it is **not close to other electrical equipment** - fridges, washing machines, microwave ovens, TVs, fluorescent lights, etc.

Cleaning and care

- Don't clean any part of your SpeakEasy 5 with benzene, thinner or other solvent chemicals - this may cause permanent damage which is not covered by the Guarantee. When necessary, **clean it with a damp cloth**.
- Keep your SpeakEasy 5 away from **hot, humid conditions** or **strong sunlight**, and don't let it get **wet**.
- Every effort has been made to ensure high standards of reliability for your SpeakEasy 5. However, if something does go wrong, please **do not try to repair it yourself** - consult your supplier or the Binatone Help Line.

Binatone Help Line - 0845 345 9677 *Calls are charged at Local Call rate.*

10. Troubleshooting

! The SpeakEasy 5 must be serviced by trained engineers. NEVER attempt any repairs or adjustments yourself - you could make the problem worse and invalidate the Guarantee.

ALWAYS check first that:

- you have followed the steps listed in Section 2 to install and set up your SpeakEasy 5.
- all connectors are firmly inserted in their sockets.
- the batteries are correctly and securely installed, and are not run down

Everyday use

"I cannot make or answer calls."

Make sure you're using the **telephone line cable** that was supplied with your SpeakEasy 5. Other telephone line cables might not work.

"The phone does not ring"

Make sure you're using the **telephone line cable** that was supplied with your SpeakEasy 5. Other telephone line cables might not work.

Check that the **total REN value** of all equipment connected to your telephone line is not more than 4. Disconnect one or more telephones.

"The phone does not dial"

Make sure you're using the **telephone line cable** that was supplied with your SpeakEasy 5. Other telephone line cables might not work.

"The Caller Display feature isn't working."

You need to **subscribe** to Caller Display service from your local telephone company. Contact the local telephone company for details on how to subscribe.

The caller may have **withheld** their number by dialing 141. Or they may be calling from a network that does not transmit the Caller Display (for example, it may be an international call).

Binatone Help Line - 0845 345 9677 Calls are charged at Local Call rate.

Troubleshooting continue...

Be sure to wait until the second ring before answering.

"ERROR message is displayed."

ERROR appears in the LCD screen if the unit detects anything other than valid Caller Display information during the silent period after the first ring. This message indicates either the presence of noise on the line, or that an invalid message has been sent from the telephone company.

Be sure to wait until the second ring before answering.

PBX use

"Last Number Redial and/or memory dialling don't work on a PBX."

When you first make a call, try pressing the **REDIAL/PAUSE** button for a **pause** between the outside line access digit (e.g. 9) and the telephone number. You should later be able to redial the number.

When storing numbers in memory, you can include the **outside line access digit** (e.g. 9) with each number.

If your PBX requires you to wait for a second Dial tone before dialing the telephone number, press the **REDIAL/PAUSE** button for a pause between the access digit and the number.

"My SpeakEasy 5 system won't work properly on a PBX."

You may need to change the **recall** setting. Call the Binatone Help Line for advice. It will help if you have your PBX documentation to hand when you make the call.

Binatone Help Line - 0845 345 9677 *Calls are charged at Local Call rate.*

Troubleshooting continue...

If the fault persists ...

Disconnect all other instruments connected to the same line as the SpeakEasy 5 and see whether you can make a call.

- **Disconnect the Base unit** from the telephone line and plug a different phone into the master telephone socket. Try making a call. If this works, the line is OK.
- If the call does not work, and you are using a **two-way socket adapter**, remove it and plug a telephone directly into the socket. If the call now works, the adapter may be faulty.

If you cannot make a call, the fault may be on the **exchange line**. Contact the service provider (the BT engineers on 151, or your cable company).

If you still cannot identify the cause of the problem, contact the **Binatone Help Line** on **0845 345 9677**. Calls are charged at Local Call rate.

11. Guarantee and service

The Binatone SpeakEasy 5 is guaranteed for 12 months from the date of purchase shown on your sales receipt. The Guarantee does not cover damage by misuse or negligence, or by excessive voltages - for example, faults on the telephone line, or lightning. This does not affect your statutory rights.

Please keep your sales (till) receipt - this is your guarantee. You should also keep the original packaging material.

In the unlikely event that you need to return your SpeakEasy 5 to our Repair Centre while it is under guarantee, there will be a £5 handling charge.

While the unit is under Guarantee

1. Disconnect the Base unit from the telephone line and the mains electricity supply.
2. Pack up all parts of your SpeakEasy 5, using the original packaging. Remember to include the mains adapter
3. Return the unit to the shop where you bought it, making sure you take your sales receipt.

After the Guarantee has expired

If the unit is no longer under Guarantee, first follow steps **1** and **2** as for repair under Guarantee. Then ...

3. Call our Service Department on **0845 345 9677** and ask for a quotation of the repair charge and details of where to send your SpeakEasy 5 for repair.
4. Make sure you include with your SpeakEasy 5:
 - your name and address.
 - a cheque or postal order for the value of the repair charge.
5. Return your SpeakEasy 5 to the address given by the Service Department.

Binatone Help Line - 0845 345 9677 Calls are charged at Local Call rate.

12. Technical details

Standard	Corded Telephone Caller Display with Speakerphone
Temperature range	Operating 0 °C to 40 °C Storage -20 °C to 60 °C
Port specification	The ☎ port (connected to the telephone line) is a TNV3 port with respect to EN41003.
PBX compatibility	Timed break recall: 98 ms. Pause length (using the REDIAL/PAUSE button): 3.6 seconds. Signalling type: DTMF (dual-tone multifrequency) also called tone dialing.
Network connection	This equipment is intended to be used in the UK only. Operation on other countries' PSTN termination points cannot be guaranteed.

Declaration of conformity

The Binatone SpeakEasy 5 complies with the essential protective requirements and objectives of:

- EC Low Voltage Directive 73/23/EEC
- EC EMC Directive 89/336/EEC

and conforms to the following relevant harmonized standards:

- Safety: EN 60950
- Other: I-CTR37, CTR38, EN55-022, EN55024



Waste electrical products must not be disposed of with household waste. This equipment should be taken to your local recycling centre for safe treatment.

Binatone operates a policy of continuous product improvement, and so reserves the right to make changes to the product and functions without notice.

Connection and conditions for use

You can connect your SpeakEasy 5 to a direct exchange line (DEL) - a line connected to a local exchange, with its own phone number; to an extension socket connected to a DEL; or to an extension on an approved compatible PBX. Do not connect the SpeakEasy 5 as an extension to a payphone.

The **ringer equivalence numbers (RENs)** of all instruments (phones, fax machines, etc.) connected to an exchange line **must not add up to more than 4** - otherwise, one or more of them may not ring and/or answer calls correctly. The SpeakEasy 5 has a REN of 1, and most other telephones have a REN of 1 unless marked otherwise.

Contents of this User Guide

1. Where to find it
2. Installation
3. Desk/Wall mount installation
4. Setting up your phone
5. Telephone operation
6. Outgoing call record
7. Phonebook function
8. Caller display operation
9. Operational notes
10. Troubleshooting
11. Guarantee and service
12. Technical details

If you need help ...

The **Binatone Help Line** is available from 9.00 am to 5.00 pm, Monday to Friday, on

0845 345 9677

Calls are charged at Local Call rate.

Pressing buttons on your phone

- When the instructions in this user guide tell you simply to **'press'** a button, this means that you should **press the button briefly, then release it**.
- When the instructions tell you to **'press and hold'** a button, this means you should **keep the button pressed** until the display changes and/or you hear a tone.

UK Ver 1 Apr 06